

# FOR MAT

## FORMAT FOR YOUR BUSINESS

FORMAT is a modern office and retail building currently under construction in the secluded part of Gdańsk Oliwa, the heart of Tricity business. One of its greatest assets is its close location to public transport, including long-distance and commuter train stations. Complimenting the building is its proximity to Oliwa Park, residential properties and the upcoming outdoor sports area.

The technological features utilised in the building will be environmentally friendly as required by its LEED certificate. This will result in a functional and running cost-efficient office building, with a floor layout that is sure to meet the needs of even the most demanding of tenants.



FORMAT – ul. Droszyńskiego 24, Gdańsk Oliwa

**TORUS**

|

**MORE [THAN] SPACE**

Purpose of the building: **office, retail**

Building class: **A**

Delivery date: **Q1 2022**

No. of storeys: **5 surface  
2 underground**

Office space: **14,107 sqm**

Gross Leasable Area: **15,999 sqm**

Parking spaces: **314 underground  
80 surface**

Certificate: **LEED, Obiekt bez barier**

**FOR  
MAT**



## LOCATION

### DISTANCES



|                              |            |
|------------------------------|------------|
| CENTER OF GDYNIA             | 30 min.    |
| CENTER OF Sopot              | 10 min.    |
| CENTER OF GDAŃSK             | 20 min.    |
| TRICITY BELTWAY              | 15 min.    |
| LECH WAŁĘSA AIRPORT          | 20 min.    |
| GDAŃSK OLİWA RAILWAY STATION | 1 min.     |
| WARSAW                       | 3h 30 min. |

### DISTANCES



|                 |         |
|-----------------|---------|
| RAILWAY STATION | 1 min.  |
| BUS             | 3 min.  |
| TRAM            | 10 min. |

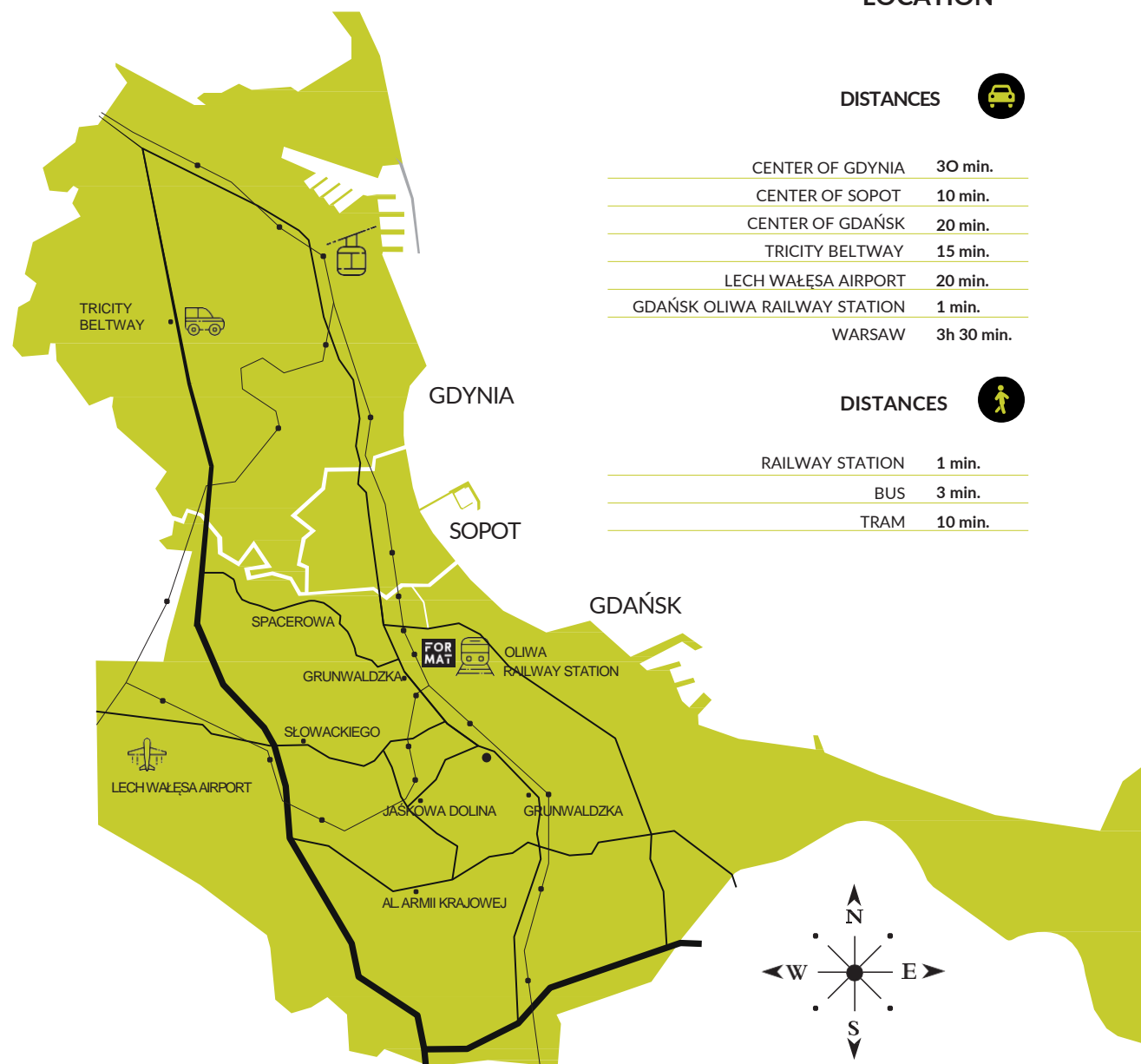



Efficient ventilation and  
air conditioning system



Tilt windows



Power supply safety



24/7 security



Representative lobby



High parking ratio



Sports infrastructure

### EXAMPLARY SURFACE DIVISION

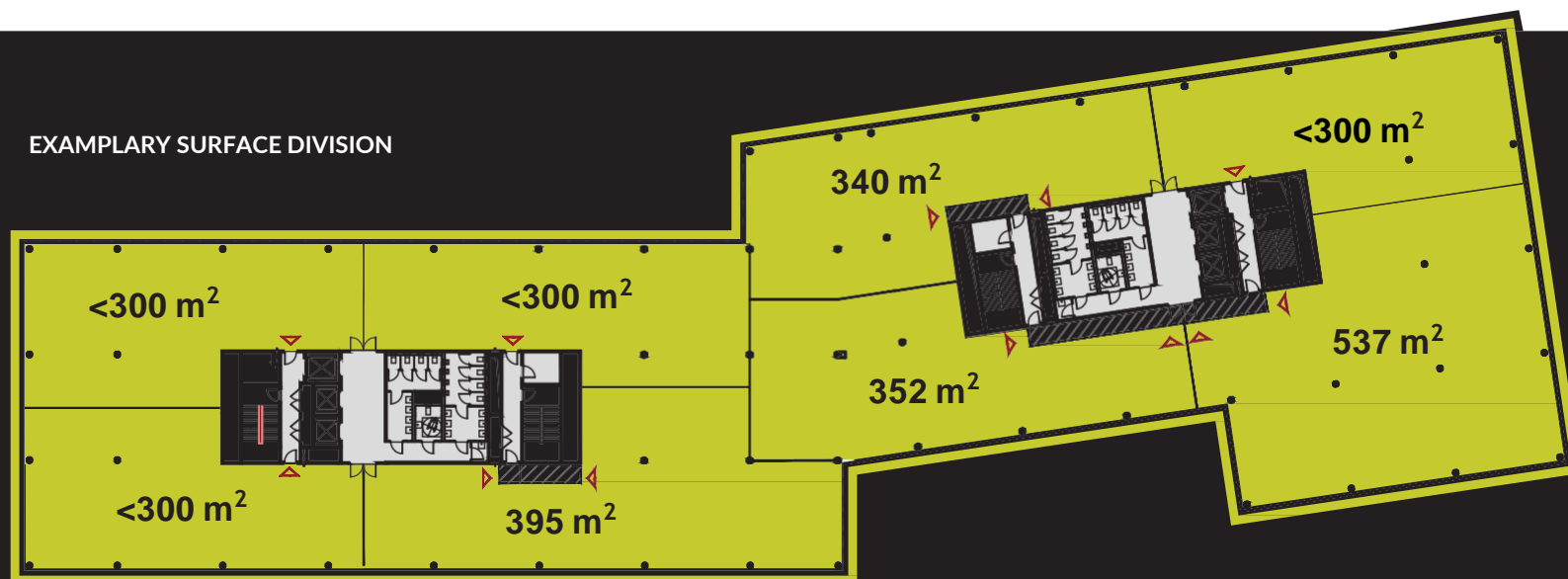

### EXAMPLARY FLOOR PLANS

